



FOR SALE

**Hazlemere Road,
Benfleet SS7 4AF**

£365,000 Freehold

- Semi-Detached Bungalow
- Three Bedrooms
- Large Lounge
- Separate Kitchen
- Detached Garage
- Driveway for Off Street Parking
- Large Front Garden
- West Facing Rear Garden
- Popular South Benfleet Location
- No Onward Chain

Selling & letting all types of property in Chalkwell,
Westcliff, Leigh, Southend and the surrounding areas.

appointmoor

Description

Three bedroom semi-detached bungalow in a popular South Benfleet location offered with no onward chain. The property has three good size bedrooms, lounge, fitted kitchen and modern shower room. Externally there are pleasant and well kept front and rear gardens, driveway for off street parking and detached garage to side aspect. Viewing advised.

Entrance

Brick wall enclosed front garden with lawn and bedding areas. Paved driveway to side entrance front door into hallway.

Lounge

Good size lounge to rear aspect with full length double glazed window and door to rear garden.

Kitchen

Fitted kitchen with a range of wall & base units, rolled edge work surface with stainless steel sink and drainer and tiled splash backs. Double glazed window to rear and door to garden.

Bedroom 1

Bedroom to front aspect with fitted carpet, double glazed window and radiator.

Bedroom 2

Bedroom to front aspect with fitted carpet, double glazed window and radiator.

Bedroom 3

Bedroom to side aspect with fitted carpet, double glazed window and radiator.

Bathroom

Three piece white suite bathroom comprising of WC, vanity wash hand basin and shower cubicle with glazed screen. Double glazed window, part tiled walls and tiled floor.

Rear Garden

Great size well kept west facing rear garden with patio, lawn and bedding areas

Garage & Parking

Detached garage to side aspect with up and over door. Paved driveway for off street parking.



GROUND FLOOR
679 sq.ft. (63.1 sq.m.) approx.

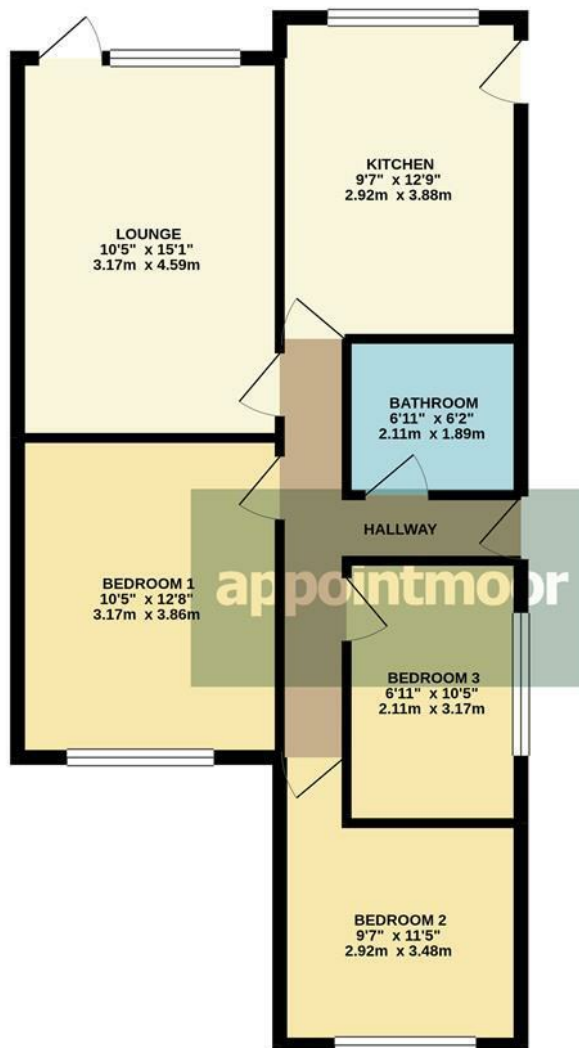

TOTAL FLOOR AREA: 679 sq.ft. (63.1 sq.m.) approx.



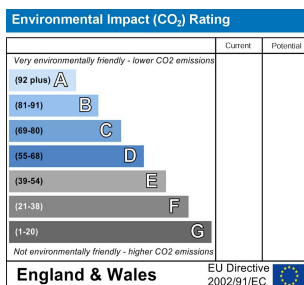
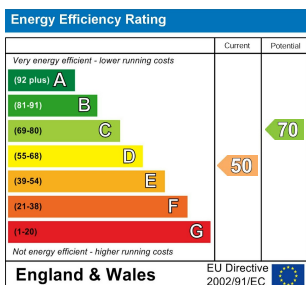

Whilst every attempt has been made to ensure the accuracy of the floorplan contained here, measurements of doors, windows, rooms and any other items are approximate and no responsibility is taken for any error, omission or mis-statement. This plan is for illustrative purposes only and should be used as such by any prospective purchaser. The services, systems and appliances shown have not been tested and no guarantee as to their operability or efficiency can be given.
Made with Metropix ©2021



AGENTS NOTES: Appointmoor Estates Ltd as our Vendors Agents have endeavoured to check the accuracy of these sales particulars, but however, can offer no guarantee. We therefore must advise any prospective purchaser employ their own, independent experts to verify the statements contained herein. Floor plans are not to scale and only provide an indication of the layout. All measurements are approximate and should not be relied upon. No equipment, utilities, circuits or fittings have been tested. **VIEWINGS: BY APPOINTMOOR ESTATES ONLY**

appointmoor

Appointmoor Sales 72 The Ridgeway,
Chalkwell, Westcliff-on-Sea, Essex, SS0 8NU
T. 01702 719966 W. appointmoor.co.uk

-  facebook.com/appointmoor
-  Instagram.com/appointmoor_estate_agents
-  twitter.com/appointmoor
-  linkedin.com/company/appointmoor